

D-Neo Washbowl # 2371400070

| < 400 mm > |

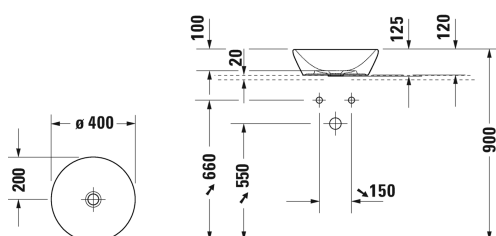

Washbowl	Dimension	Weight	Order number
without overflow, without tap platform, fixings included, 400 mm			
Colors			
00 White Alpin			
Variant			
☒	400 x 400 mm	7.300 kilogram	2371400070
Infobox			
When using this siphon in black matt, please see recommendation of black matt accessoires from page XXX			
Sanitary ceramics with the special WonderGliss surface finish will remain clean and attractive-looking for a long time to come. When ordering WonderGliss please add a "1" as eleventh digit to the model number.			
Accessory			
Slotted waste for washbasins without overflow	50 mm	0.300 kilogram	005024
Design Siphon		1.500 kilogram	005036
Suitable products			
Vanity unit wall-mounted 1 pull-out compartment, countertop including one cut-out, for 1 above counter basin central, 800 x 550 mm	800 x 550 mm		KT6694
Vanity unit wall-mounted 1 pull-out compartment, countertop including one cut-out, for 1 above counter basin central, 1000 x 550 mm	1000 x 550 mm		KT6695
Vanity unit wall-mounted 2 drawers, upper drawer including cut-out for siphon and siphon cover, countertop including one cut-out, for 1 above counter basin central, 800 x 550 mm	800 x 550 mm		KT6654
Vanity unit wall-mounted 2 drawers, upper drawer including cut-out for siphon and siphon cover, countertop including one cut-out, for 1 above counter basin central, 1000 x 550 mm	1000 x 550 mm		KT6655
Vanity unit wall-mounted 1 pull-out compartment, countertop including one cut-out, 1000 x 550 mm	1000 x 550 mm		DS6784 L/R

D-Neo Washbowl # 2371400070

|< 400 mm >|

Vanity unit wall-mounted 2 pull-out compartments, 1 console with one cut-out, 1400 x 550 mm	1400 x 550 mm	DS6785 L/R
Vanity unit for console compact 1 pull-out compartment, compartment consists of glass dividers and 2 boxes (small/large), 600 x 478 mm	600 x 478 mm	XL5400
Vanity unit for console compact 1 pull-out compartment, compartment consists of glass dividers and 2 boxes (small/large), 700 x 478 mm	700 x 478 mm	XL5401
Vanity unit for console compact 1 pull-out compartment, compartment consists of glass dividers and 2 boxes (small/large), 800 x 478 mm	800 x 478 mm	XL5402
Vanity unit for console compact 1 pull-out compartment, compartment consists of glass dividers and 2 boxes (small/large), 900 x 478 mm	900 x 478 mm	XL5403
Vanity unit for console compact 1 pull-out compartment, compartment consists of glass dividers and 2 boxes (small/large), 1000 x 478 mm	1000 x 478 mm	XL5404
Vanity unit for console compact 2 drawers, upper drawer including cut-out for siphon and siphon cover, 600 x 478 mm	600 x 478 mm	XL5405
Vanity unit for console compact 2 drawers, upper drawer including cut-out for siphon and siphon cover, 700 x 478 mm	700 x 478 mm	XL5406
Vanity unit for console compact 2 drawers, upper drawer including cut-out for siphon and siphon cover, 800 x 478 mm	800 x 478 mm	XL5407
Vanity unit for console compact 2 drawers, upper drawer including cut-out for siphon and siphon cover, 900 x 478 mm	900 x 478 mm	XL5408
Vanity unit for console compact 2 drawers, upper drawer including cut-out for siphon and siphon cover, 1000 x 478 mm	1000 x 478 mm	XL5409
Vanity unit for console 1 pull-out compartment, compartment consists of glass dividers and 2 boxes (small/large), 600 x 548 mm	600 x 548 mm	XL5410
Vanity unit for console 1 pull-out compartment, compartment consists of glass dividers and 2 boxes (small/large), 700 x 548 mm	700 x 548 mm	XL5411
Vanity unit for console 1 pull-out compartment, compartment consists of glass dividers and 2 boxes (small/large), 800 x 548 mm	800 x 548 mm	XL5412
Vanity unit for console 1 pull-out compartment, compartment consists of glass dividers and 2 boxes (small/large), 900 x 548 mm	900 x 548 mm	XL5413
Vanity unit for console 1 pull-out compartment, compartment consists of glass dividers and 2 boxes (small/large), 1000 x 548 mm	1000 x 548 mm	XL5414
Vanity unit for console 2 drawers, upper drawer including cut-out for siphon and siphon cover, 600 x 548 mm	600 x 548 mm	XL5415
Vanity unit for console 2 drawers, upper drawer including cut-out for siphon and siphon cover, 700 x 548 mm	700 x 548 mm	XL5416
Vanity unit for console 2 drawers, upper drawer including cut-out for siphon and siphon cover, 800 x 548 mm	800 x 548 mm	XL5417
Vanity unit for console 2 drawers, upper drawer including cut-out for siphon and siphon cover, 900 x 548 mm	900 x 548 mm	XL5418

D-Neo Washbowl # 2371400070

|< 400 mm >|

Vanity unit for console 2 drawers, upper drawer including cut-out for siphon and siphon cover, 1000 x 548 mm	1000 x 548 mm	XL5419
Vanity unit for console compact 1 pull-out compartment, 600 x 478 mm	600 x 478 mm	DS5300
Vanity unit for console compact 1 pull-out compartment, 700 x 478 mm	700 x 478 mm	DS5301
Vanity unit for console compact 1 pull-out compartment, 800 x 478 mm	800 x 478 mm	DS5302
Vanity unit for console compact 1 pull-out compartment, 900 x 478 mm	900 x 478 mm	DS5303
Vanity unit for console compact 1 pull-out compartment, 1000 x 478 mm	1000 x 478 mm	DS5304
Vanity unit for console compact 2 drawers, upper drawer including cut-out for siphon and siphon cover, 600 x 478 mm	600 x 478 mm	DS5305
Vanity unit for console compact 2 drawers, upper drawer including cut-out for siphon and siphon cover, 700 x 478 mm	700 x 478 mm	DS5306
Vanity unit for console compact 2 drawers, upper drawer including cut-out for siphon and siphon cover, 800 x 478 mm	800 x 478 mm	DS5307
Vanity unit for console compact 2 drawers, upper drawer including cut-out for siphon and siphon cover, 900 x 478 mm	900 x 478 mm	DS5308
Vanity unit for console compact 2 drawers, upper drawer including cut-out for siphon and siphon cover, 1000 x 478 mm	1000 x 478 mm	DS5309
Vanity unit for console 1 pull-out compartment, 600 x 548 mm	600 x 548 mm	DS5310
Vanity unit for console 1 pull-out compartment, 700 x 548 mm	700 x 548 mm	DS5311
Vanity unit for console 1 pull-out compartment, 800 x 548 mm	800 x 548 mm	DS5312
Vanity unit for console 1 pull-out compartment, 900 x 548 mm	900 x 548 mm	DS5313
Vanity unit for console 1 pull-out compartment, 1000 x 548 mm	1000 x 548 mm	DS5314
Vanity unit for console 2 drawers, upper drawer including cut-out for siphon and siphon cover, 600 x 548 mm	600 x 548 mm	DS5315
Vanity unit for console 2 drawers, upper drawer including cut-out for siphon and siphon cover, 700 x 548 mm	700 x 548 mm	DS5316
Vanity unit for console 2 drawers, upper drawer including cut-out for siphon and siphon cover, 800 x 548 mm	800 x 548 mm	DS5317
Vanity unit for console 2 drawers, upper drawer including cut-out for siphon and siphon cover, 900 x 548 mm	900 x 548 mm	DS5318
Vanity unit for console 2 drawers, upper drawer including cut-out for siphon and siphon cover, 1000 x 548 mm	1000 x 548 mm	DS5319
Vanity unit for console compact 1 pull-out compartment, 620 x 477 mm	620 x 477 mm	LC5800
Vanity unit for console compact 1 pull-out compartment, 720 x 477 mm	720 x 477 mm	LC5801
Vanity unit for console compact 1 pull-out compartment, 820 x 477 mm	820 x 477 mm	LC5802
Vanity unit for console compact 1 pull-out compartment, 920 x 477 mm	920 x 477 mm	LC5803

D-Neo Washbowl # 2371400070

|< 400 mm >|

Vanity unit for console compact 1 pull-out compartment, 1020 x 477 mm	1020 x 477 mm	LC5804
Vanity unit for console compact 2 drawers, upper drawer including cut-out for siphon and siphon cover, 620 x 477 mm	620 x 477 mm	LC5805
Vanity unit for console compact 2 drawers, upper drawer including cut-out for siphon and siphon cover, 720 x 477 mm	720 x 477 mm	LC5806
Vanity unit for console compact 2 drawers, upper drawer including cut-out for siphon and siphon cover, 820 x 477 mm	820 x 477 mm	LC5807
Vanity unit for console compact 2 drawers, upper drawer including cut-out for siphon and siphon cover, 920 x 477 mm	920 x 477 mm	LC5808
Vanity unit for console compact 2 drawers, upper drawer including cut-out for siphon and siphon cover, 1020 x 477 mm	1020 x 477 mm	LC5809
Vanity unit for console 1 pull-out compartment, 620 x 547 mm	620 x 547 mm	LC5810
Vanity unit for console 1 pull-out compartment, 720 x 547 mm	720 x 547 mm	LC5811
Vanity unit for console 1 pull-out compartment, 820 x 547 mm	820 x 547 mm	LC5812
Vanity unit for console 1 pull-out compartment, 920 x 547 mm	920 x 547 mm	LC5813
Vanity unit for console 1 pull-out compartment, 1020 x 547 mm	1020 x 547 mm	LC5814
Vanity unit for console 2 drawers, upper drawer including cut-out for siphon and siphon cover, 620 x 547 mm	620 x 547 mm	LC5815
Vanity unit for console 2 drawers, upper drawer including cut-out for siphon and siphon cover, 720 x 547 mm	720 x 547 mm	LC5816
Vanity unit for console 2 drawers, upper drawer including cut-out for siphon and siphon cover, 820 x 547 mm	820 x 547 mm	LC5817
Vanity unit for console 2 drawers, upper drawer including cut-out for siphon and siphon cover, 920 x 547 mm	920 x 547 mm	LC5818
Vanity unit for console 2 drawers, upper drawer including cut-out for siphon and siphon cover, 1020 x 547 mm	1020 x 547 mm	LC5819
Vanity unit for console compact 1 pull-out compartment, 620 x 480 mm	620 x 480 mm	BR5100
Vanity unit for console compact 1 pull-out compartment, 720 x 480 mm	720 x 480 mm	BR5101
Vanity unit for console compact 1 pull-out compartment, 820 x 480 mm	820 x 480 mm	BR5102
Vanity unit for console compact 1 pull-out compartment, 920 x 480 mm	920 x 480 mm	BR5103
Vanity unit for console compact 1 pull-out compartment, 1020 x 480 mm	1020 x 480 mm	BR5104
Vanity unit for console compact 2 drawers, upper drawer including cut-out for siphon and siphon cover, 620 x 480 mm	620 x 480 mm	BR5105
Vanity unit for console compact 2 drawers, upper drawer including cut-out for siphon and siphon cover, 720 x 480 mm	720 x 480 mm	BR5106
Vanity unit for console compact 2 drawers, upper drawer including cut-out for siphon and siphon cover, 820 x 480 mm	820 x 480 mm	BR5107
Vanity unit for console compact 2 drawers, upper drawer including cut-out for siphon and siphon cover, 920 x 480 mm	920 x 480 mm	BR5108

D-Neo Washbowl # 2371400070

|< 400 mm >|

Vanity unit for console compact 2 drawers, upper drawer including cut-out for siphon and siphon cover, 1020 x 480 mm	1020 x 480 mm	BR5109
Vanity unit for console 1 pull-out compartment, 620 x 550 mm	620 x 550 mm	BR5110
Vanity unit for console 1 pull-out compartment, 720 x 550 mm	720 x 550 mm	BR5111
Vanity unit for console 1 pull-out compartment, 820 x 550 mm	820 x 550 mm	BR5112
Vanity unit for console 1 pull-out compartment, 920 x 550 mm	920 x 550 mm	BR5113
Vanity unit for console 1 pull-out compartment, 1020 x 550 mm	1020 x 550 mm	BR5114
Vanity unit for console 2 drawers, upper drawer including cut-out for siphon and siphon cover, 620 x 550 mm	620 x 550 mm	BR5115
Vanity unit for console 2 drawers, upper drawer including cut-out for siphon and siphon cover, 720 x 550 mm	720 x 550 mm	BR5116
Vanity unit for console 2 drawers, upper drawer including cut-out for siphon and siphon cover, 820 x 550 mm	820 x 550 mm	BR5117
Vanity unit for console 2 drawers, upper drawer including cut-out for siphon and siphon cover, 920 x 550 mm	920 x 550 mm	BR5118
Vanity unit for console 2 drawers, upper drawer including cut-out for siphon and siphon cover, 1020 x 550 mm	1020 x 550 mm	BR5119
Vanit unit for console wall-mounted 1 pull-out compartment, 800 x 548 mm	800 x 548 mm	XS4900
Vanit unit for console wall-mounted 1 pull-out compartment, 1000 x 548 mm	1000 x 548 mm	XS4901
Vanit unit for console wall-mounted 1 pull-out compartment, 1200 x 548 mm	1200 x 548 mm	XS4902
Vanit unit for console wall-mounted 2 drawers, upper drawer including cut-out for siphon and siphon cover, 800 x 548 mm	800 x 548 mm	XS4910
Vanit unit for console wall-mounted 2 drawers, upper drawer including cut-out for siphon and siphon cover, 1000 x 548 mm	1000 x 548 mm	XS4911
Vanit unit for console wall-mounted 2 drawers, upper drawer including cut-out for siphon and siphon cover, 1200 x 548 mm	1200 x 548 mm	XS4912
Vanit unit for console floor-standing 2 pull-out compartments, integrated base frame legs with height adjustement, 800 x 548 mm	800 x 548 mm	XS4920
Vanit unit for console floor-standing 2 pull-out compartments, integrated base frame legs with height adjustement, 1000 x 548 mm	1000 x 548 mm	XS4921
Vanit unit for console floor-standing 2 pull-out compartments, integrated base frame legs with height adjustement, 1200 x 548 mm	1200 x 548 mm	XS4922
Vanit unit for console wall-mounted 2 pull-out compartments, 1400 x 548 mm	1400 x 548 mm	XS4903 L/R
Vanit unit for console wall-mounted 2 pull-out compartments, 1600 x 548 mm	1600 x 548 mm	XS4904 R/L
Vanit unit for console wall-mounted 4 drawers, 1400 x 548 mm	1400 x 548 mm	XS4913 L/R
Vanit unit for console wall-mounted 4 drawers, 1600 x 548 mm	1600 x 548 mm	XS4914 L/R

D-Neo Washbowl # 2371400070

|< 400 mm >|

Vanit unit for console floor-standing 4 pull-out compartments, integrated base frame legs with height adjustement, 1400 x 548 mm	1400 x 548 mm	XS4923 R/L
Vanit unit for console floor-standing 4 pull-out compartments, integrated base frame legs with height adjustement, 1600 x 548 mm	1600 x 548 mm	XS4924 L/R
Vanit unit for console wall-mounted 2 pull-out compartments, 1400 x 548 mm	1400 x 548 mm	XS4906 B
Vanit unit for console wall-mounted 2 pull-out compartments, 1600 x 548 mm	1600 x 548 mm	XS4907 B
Vanit unit for console wall-mounted 4 drawers, upper drawer including cut-out for siphon and siphon cover, 1400 x 548 mm	1400 x 548 mm	XS4916 B
Vanit unit for console wall-mounted 4 drawers, upper drawer including cut-out for siphon and siphon cover, 1600 x 548 mm	1600 x 548 mm	XS4917 B
Vanit unit for console floor-standing 4 pull-out compartments, integrated base frame legs with height adjustement, 1400 x 548 mm	1400 x 548 mm	XS4926 B
Vanit unit for console floor-standing 4 pull-out compartments, integrated base frame legs with height adjustement, 1600 x 548 mm	1600 x 548 mm	XS4927 B
Vanity unit for console compact 1 pull-out compartment, 632 x 478 mm	632 x 478 mm	XV5900
Vanity unit for console compact 1 pull-out compartment, 732 x 478 mm	732 x 478 mm	XV5901
Vanity unit for console compact 1 pull-out compartment, 832 x 478 mm	832 x 478 mm	XV5902
Vanity unit for console compact 1 pull-out compartment, 932 x 478 mm	932 x 478 mm	XV5903
Vanity unit for console compact 1 pull-out compartment, 1032 x 478 mm	1032 x 478 mm	XV5904
Vanity unit for console compact 2 drawers, upper drawer including cut-out for siphon and siphon cover, 632 x 478 mm	632 x 478 mm	XV5905
Vanity unit for console compact 2 drawers, upper drawer including cut-out for siphon and siphon cover, 732 x 478 mm	732 x 478 mm	XV5906
Vanity unit for console compact 2 drawers, upper drawer including cut-out for siphon and siphon cover, 832 x 478 mm	832 x 478 mm	XV5907
Vanity unit for console compact 2 drawers, upper drawer including cut-out for siphon and siphon cover, 932 x 478 mm	932 x 478 mm	XV5908
Vanity unit for console compact 2 drawers, upper drawer including cut-out for siphon and siphon cover, 1032 x 478 mm	1032 x 478 mm	XV5909
Vanity unit for console 1 pull-out compartment, 632 x 548 mm	632 x 548 mm	XV5910
Vanity unit for console 1 pull-out compartment, 732 x 548 mm	732 x 548 mm	XV5911
Vanity unit for console 1 pull-out compartment, 832 x 548 mm	832 x 548 mm	XV5912
Vanity unit for console 1 pull-out compartment, 932 x 548 mm	932 x 548 mm	XV5913
Vanity unit for console 1 pull-out compartment, 1032 x 548 mm	1032 x 548 mm	XV5914

D-Neo Washbowl # 2371400070

| < 400 mm > |

Vanity unit for console 2 drawers, upper drawer including cut-out for siphon and siphon cover, 632 x 548 mm	632 x 548 mm	XV5915
Vanity unit for console 2 drawers, upper drawer including cut-out for siphon and siphon cover, 732 x 548 mm	732 x 548 mm	XV5916
Vanity unit for console 2 drawers, upper drawer including cut-out for siphon and siphon cover, 832 x 548 mm	832 x 548 mm	XV5917
Vanity unit for console 2 drawers, upper drawer including cut-out for siphon and siphon cover, 932 x 548 mm	932 x 548 mm	XV5918
Vanity unit for console 2 drawers, upper drawer including cut-out for siphon and siphon cover, 1032 x 548 mm	1032 x 548 mm	XV5919
Console for above counter basin and countertop basin 1 console with one cut-out, price per section of 100 mm, basic price till 800 mm, 45 mm thickness, 550 mm	550 mm	BR102C
Console for above counter basin and countertop basin 1 console with two cut-outs, price per section of 100 mm, basic price till 800 mm, 45 mm thickness, 550 mm	550 mm	BR103C
Console for above counter basin and countertop basin 1 console with one cut-out, price per section of 100 mm, basic price till 800 mm, 30 mm thickness, 550 mm	550 mm	BR106C
Console for above counter basin and countertop basin 1 console with two cut-outs, price per section of 100 mm, basic price till 800 mm, 30 mm thickness, 550 mm	550 mm	BR107C
Console for above counter basin and countertop basin compact 1 console with one cut-out, price per section of 100 mm, basic price till 800 mm, 45 mm thickness, 480 mm	480 mm	BR100C
Console for above counter basin and countertop basin compact 1 console with two cut-outs, price per section of 100 mm, basic price till 800 mm, 45 mm thickness, 480 mm	480 mm	BR101C
Console for above counter basin and countertop basin compact 1 console with one cut-out, price per section of 100 mm, basic price till 800 mm, 30 mm thickness, 480 mm	480 mm	BR104C
Console for above counter basin and countertop basin compact 1 console with two cut-outs, price per section of 100 mm, basic price till 800 mm, 30 mm thickness, 480 mm	480 mm	BR105C
Console for above counter basin and countertop basin 1 console with one cut-out, price per section of 100 mm, basic price till 800 mm, 45 mm thickness, 550 mm	550 mm	DS102C
Console for above counter basin and countertop basin 1 console with two cut-outs, price per section of 100 mm, basic price till 800 mm, 45 mm thickness, 550 mm	550 mm	DS103C
Console for above counter basin and countertop basin 1 console with one cut-out, price per section of 100 mm, basic price till 800 mm, 30 mm thickness, 550 mm	550 mm	DS106C
Console for above counter basin and countertop basin 1 console with two cut-outs, price per section of 100 mm, basic price till 800 mm, 30 mm thickness, 550 mm	550 mm	DS107C
Console for above counter basin and countertop basin 1 console with one cut-out, price per section of 100 mm, basic price till 800 mm, 45 mm thickness, 550 mm	550 mm	LC102C

D-Neo Washbowl # 2371400070

|< 400 mm >|

Console for above counter basin and countertop basin 1 console with two cut-outs, price per section of 100 mm, basic price till 800 mm, 45 mm thickness, 550 mm	550 mm	LC103C
Console for above counter basin and countertop basin 1 console with one cut-out, price per section of 100 mm, basic price till 800 mm, 30 mm thickness, 550 mm	550 mm	LC106C
Console for above counter basin and countertop basin 1 console with two cut-outs, price per section of 100 mm, basic price till 800 mm, 30 mm thickness, 550 mm	550 mm	LC107C
Console for above counter basin and countertop basin 1 console with one cut-out, price per section of 100 mm, basic price till 800 mm, 45 mm thickness, 550 mm	550 mm	XL102C
Console for above counter basin and countertop basin 1 console with two cut-outs, price per section of 100 mm, basic price till 800 mm, 45 mm thickness, 550 mm	550 mm	XL103C
Console for above counter basin and countertop basin 1 console with one cut-out, price per section of 100 mm, basic price till 800 mm, 30 mm thickness, 550 mm	550 mm	XL106C
Console for above counter basin and countertop basin 1 console with two cut-outs, price per section of 100 mm, basic price till 800 mm, 30 mm thickness, 550 mm	550 mm	XL107C
Console for above counter basin and countertop basin 1 console with one cut-out, price per section of 100 mm, basic price till 800 mm, 45 mm thickness, 550 mm	550 mm	XV102C
Console for above counter basin and countertop basin 1 console with two cut-outs, price per section of 100 mm, basic price till 800 mm, 45 mm thickness, 550 mm	550 mm	XV103C
Console for above counter basin and countertop basin 1 console with two cut-outs, price per section of 100 mm, basic price till 800 mm, 30 mm thickness, 550 mm	550 mm	XV107C
Console for above counter basin and countertop basin compact 1 console with one cut-out, price per section of 100 mm, basic price till 800 mm, 45 mm thickness, 480 mm	480 mm	DS100C
Console for above counter basin and countertop basin compact 1 console with two cut-outs, price per section of 100 mm, basic price till 800 mm, 45 mm thickness, 480 mm	480 mm	DS101C
Console for above counter basin and countertop basin compact 1 console with one cut-out, price per section of 100 mm, basic price till 800 mm, 30 mm thickness, 480 mm	480 mm	DS104C
Console for above counter basin and countertop basin compact 1 console with two cut-outs, price per section of 100 mm, basic price till 800 mm, 30 mm thickness, 480 mm	480 mm	DS105C
Console for above counter basin and countertop basin compact 1 console with one cut-out, price per section of 100 mm, basic price till 800 mm, 45 mm thickness, 480 mm	480 mm	LC100C
Console for above counter basin and countertop basin compact 1 console with two cut-outs, price per section of 100 mm, basic price till 800 mm, 45 mm thickness, 480 mm	480 mm	LC101C
Console for above counter basin and countertop basin compact 1 console with one cut-out, price per section of 100 mm, basic price till 800 mm, 30 mm thickness, 480 mm	480 mm	LC104C

D-Neo Washbowl # 2371400070

| < 400 mm > |

Console for above counter basin and countertop basin compact 1 console with two cut-outs, price per section of 100 mm, basic price till 800 mm, 30 mm thickness, 480 mm	480 mm	LC105C
Console for above counter basin and countertop basin compact 1 console with one cut-out, price per section of 100 mm, basic price till 800 mm, 45 mm thickness, 480 mm	480 mm	XL100C
Console for above counter basin and countertop basin compact 1 console with two cut-outs, price per section of 100 mm, basic price till 800 mm, 45 mm thickness, 480 mm	480 mm	XL101C
Console for above counter basin and countertop basin compact 1 console with one cut-out, price per section of 100 mm, basic price till 800 mm, 30 mm thickness, 480 mm	480 mm	XL104C
Console for above counter basin and countertop basin compact 1 console with two cut-outs, price per section of 100 mm, basic price till 800 mm, 30 mm thickness, 480 mm	480 mm	XL105C
Console for above counter basin and countertop basin compact 1 console with one cut-out, price per section of 100 mm, basic price till 800 mm, 45 mm thickness, 480 mm	480 mm	XV100C
Console for above counter basin and countertop basin compact 1 console with two cut-outs, price per section of 100 mm, basic price till 800 mm, 45 mm thickness, 480 mm	480 mm	XV101C
Console for above counter basin and countertop basin compact 1 console with one cut-out, price per section of 100 mm, basic price till 800 mm, 30 mm thickness, 480 mm	480 mm	XV104C
Console for above counter basin and countertop basin compact 1 console with two cut-outs, price per section of 100 mm, basic price till 800 mm, 30 mm thickness, 480 mm	480 mm	XV105C
Console for above counter basin and countertop basin compact 1 console with one cut-out, price per section of 100 mm, basic price till 800 mm, 30 mm thickness, 550 mm	550 mm	XV106C
Vanity unit wall-mounted 1 pull-out compartment, 1 console with one cut-out, 800 x 550 mm	800 x 550 mm	WT4975
Vanity unit wall-mounted 1 pull-out compartment, 1 console with one cut-out, 1000 x 550 mm	1000 x 550 mm	WT4976
Vanity unit wall-mounted 1 pull-out compartment, 1 console with one cut-out, 1300 x 550 mm	1300 x 550 mm	WT4977 L/R/M
Vanity unit wall-mounted 1 pull-out compartment, 1 console with two cut-outs, 1300 x 550 mm	1300 x 550 mm	WT4978 B
Vanity unit wall-mounted 2 drawers, upper drawer including cut-out for siphon and siphon cover, 1 console with one cut-out, 800 x 550 mm	800 x 550 mm	WT4985
Vanity unit wall-mounted 2 drawers, upper drawer including cut-out for siphon and siphon cover, 1 console with one cut-out, 1000 x 550 mm	1000 x 550 mm	WT4986
Vanity unit wall-mounted 2 drawers, upper drawer including cut-out for siphon and siphon cover, 1 console with one cut-out, 1300 x 550 mm	1300 x 550 mm	WT4987 L/R/M
Vanity unit wall-mounted 2 drawers, upper drawer including cut-out for siphon and siphon cover, 1 console with two cut-outs, 1300 x 550 mm	1300 x 550 mm	WT4988 B

D-Neo Washbowl # 2371400070

|< 400 mm >|

Vanity unit wall-mounted 1 pull-out compartment, 1 console with one cut-out, 800 x 550 mm	800 x 550 mm	WT4980
Vanity unit wall-mounted 1 pull-out compartment, 1 console with one cut-out, 1000 x 550 mm	1000 x 550 mm	WT4981
Vanity unit wall-mounted 1 pull-out compartment, 1 console with one cut-out, 1300 x 550 mm	1300 x 550 mm	WT4982 L/R/M
Vanity unit wall-mounted 1 pull-out compartment, 1 console with two cut-outs, 1300 x 550 mm	1300 x 550 mm	WT4983 B
Vanity unit wall-mounted 2 drawers, upper drawer including cut-out for siphon and siphon cover, 1 console with one cut-out, 800 x 550 mm	800 x 550 mm	WT4990
Vanity unit wall-mounted 2 drawers, upper drawer including cut-out for siphon and siphon cover, 1 console with one cut-out, 1000 x 550 mm	1000 x 550 mm	WT4991
Vanity unit wall-mounted 2 drawers, upper drawer including cut-out for siphon and siphon cover, 1 console with one cut-out, 1300 x 550 mm	1300 x 550 mm	WT4992 L/R/M
Vanity unit wall-mounted 2 drawers, upper drawer including cut-out for siphon and siphon cover, 1 console with two cut-outs, 1300 x 550 mm	1300 x 550 mm	WT4993 B
Vanity unit wall-mounted 1 pull-out compartment, 1 console with one cut-out, 800 x 550 mm	800 x 550 mm	DE4947
Vanity unit wall-mounted 1 pull-out compartment, 1 console with one cut-out, 1000 x 550 mm	1000 x 550 mm	DE4948
Vanity unit wall-mounted 1 pull-out compartment, 1 console with one cut-out, 1200 x 550 mm	1200 x 550 mm	DE4949
Vanity unit wall-mounted 2 pull-out compartments, 1 opened shelf incl. wooden floor, 1 countertop with one cut-out or two cut-outs, 1400 x 550 mm	1400 x 550 mm	DE4950 B/L/R
Vanity unit wall-mounted 1 drawer, 1 pull-out compartment, upper drawer including cut-out for siphon and siphon cover, 1 console with one cut-out, 800 x 550 mm	800 x 550 mm	DE4967
Vanity unit wall-mounted 1 drawer, 1 pull-out compartment, upper drawer including cut-out for siphon and siphon cover, 1 console with one cut-out, 1000 x 550 mm	1000 x 550 mm	DE4968
Vanity unit wall-mounted 1 drawer, 1 pull-out compartment, upper drawer including cut-out for siphon and siphon cover, 1 console with one cut-out, 1200 x 550 mm	1200 x 550 mm	DE4969
Vanity unit wall-mounted 2 drawers, 2 pull-out compartments, drawer beneath basin including cut-out for siphon and siphon cover, 1 opened shelf incl. wooden floor, 1 countertop with one cut-out or two cut-outs, 1400 x 550 mm	1400 x 550 mm	DE4970 B/L/R
Vanity unit wall-mounted compact 1 open compartment on the right side, 1 console with one cut-out, 800 x 480 mm	800 x 480 mm	DE4918
Vanity unit wall-mounted 1 open compartment on the right side, 1 console with one cut-out, 800 x 550 mm	800 x 550 mm	DE4928
Vanity unit wall-mounted 1 open compartment on the right side, 1 console with one cut-out, 1000 x 550 mm	1000 x 550 mm	DE4929
Vanity unit wall-mounted compact 1 open compartment on the right side, 1 console with one cut-out, 1000 x 480 mm	1000 x 480 mm	DE4919

D-Neo Washbowl # 2371400070

|< 400 mm >|

Vanity unit wall-mounted compact 1 open compartment on the left side, 1 console with one cut-out, 800 x 480 mm	800 x 480 mm	DE4938
Vanity unit wall-mounted compact 1 open compartment on the left side, 1 console with one cut-out, 1000 x 480 mm	1000 x 480 mm	DE4939
Vanity unit wall-mounted 1 open compartment on the left side, 1 console with one cut-out, 800 x 550 mm	800 x 550 mm	DE4958
Vanity unit wall-mounted 1 open compartment on the left side, 1 console with one cut-out, 1000 x 550 mm	1000 x 550 mm	DE4959
Vanity unit wall-mounted 2 drawers, upper drawer including cut-out for siphon and siphon cover, 1 console with one cut-out, 800 x 550 mm	800 x 550 mm	XV4770
Vanity unit wall-mounted 2 drawers, upper drawer including cut-out for siphon and siphon cover, 1 console with one cut-out, 1000 x 550 mm	1000 x 550 mm	XV4771
Vanity unit wall-mounted 2 drawers, upper drawer including cut-out for siphon and siphon cover, 1 console with one cut-out, 1200 x 550 mm	1200 x 550 mm	XV4772
Vanity unit wall-mounted 4 drawers, upper drawer including cut-out for siphon and siphon cover, 1 console with one cut-out, 1400 x 550 mm	1400 x 550 mm	XV4773 L/R
Vanity unit wall-mounted 4 drawers, upper drawer including cut-out for siphon and siphon cover, 1 console with one cut-out, 1600 x 550 mm	1600 x 550 mm	XV4775 L/R
Vanity unit wall-mounted 4 drawers, upper drawer including cut-out for siphon and siphon cover, 1 console with two cut-outs, 1400 x 550 mm	1400 x 550 mm	XV4774 B
Vanity unit wall-mounted 4 drawers, upper drawer including cut-out for siphon and siphon cover, 1 console with two cut-outs, 1600 x 550 mm	1600 x 550 mm	XV4776 B
Vanity unit wall-mounted 1 pull-out compartment, 1 console with one cut-out, 800 x 550 mm	800 x 550 mm	K24885
Vanity unit wall-mounted 1 pull-out compartment, 1 console with one cut-out, 1000 x 550 mm	1000 x 550 mm	K24886
Vanity unit wall-mounted 1 pull-out compartment, 1 console with one cut-out, 1200 x 550 mm	1200 x 550 mm	K24887
Vanity unit wall-mounted 2 pull-out compartments, 1 countertop with one cut-out or two cut-outs, 1400 x 550 mm	1400 x 550 mm	K24888 B/L/R
Vanity unit wall-mounted 2 pull-out compartments, 1 countertop with one cut-out or two cut-outs, 1600 x 550 mm	1600 x 550 mm	K24889 L/B/R
Vanity unit wall-mounted 2 drawers, upper drawer including cut-out for siphon and siphon cover, 1 console with one cut-out, 800 x 550 mm	800 x 550 mm	K24895
Vanity unit wall-mounted 2 drawers, upper drawer including cut-out for siphon and siphon cover, 1 console with one cut-out, 1000 x 550 mm	1000 x 550 mm	K24896
Vanity unit wall-mounted 2 drawers, upper drawer including cut-out for siphon and siphon cover, 1 console with one cut-out, 1200 x 550 mm	1200 x 550 mm	K24897
Vanity unit wall-mounted 4 drawers, 1 countertop with one cut-out or two cut-outs, 1400 x 550 mm	1400 x 550 mm	K24898 B/L/R

D-Neo Washbowl # 2371400070

|< 400 mm >|

Vanity unit wall-mounted 4 drawers, 1 countertop with one cut-out or two cut-outs, 1600 x 550 mm	1600 x 550 mm	K24899 B/L/R
Vanity unit wall-mounted 2 pull-out compartments, 1 console with one cut-out, 1600 x 550 mm	1600 x 550 mm	WT4864 L/R
Vanity unit wall-mounted 2 pull-out compartments, 1 console with two cut-outs, 1600 x 550 mm	1600 x 550 mm	WT4865 B
Vanity unit wall-mounted 2 pull-out compartments, 1 console with one cut-out, 1600 x 550 mm	1600 x 550 mm	WT4890 L/R
Vanity unit wall-mounted 2 pull-out compartments, 1 console with two cut-outs, 1600 x 550 mm	1600 x 550 mm	WT4891 B
Vanity unit wall-mounted 4 drawers, 1 console with one cut-out, 1600 x 550 mm	1600 x 550 mm	WT4867 L/R
Vanity unit wall-mounted 1 console with two cut-outs, upper drawer including cut-out for siphon and siphon cover, 4 drawers, 1600 x 550 mm	1600 x 550 mm	WT4868 B
Vanity unit wall-mounted 4 drawers, 1 console with one cut-out, 1600 x 550 mm	1600 x 550 mm	WT4995 L/R
Vanity unit wall-mounted 1 console with two cut-outs, upper drawer including cut-out for siphon and siphon cover, 4 drawers, 1600 x 550 mm	1600 x 550 mm	WT4996 B
Vanity unit wall-mounted 1 drawer, 1 pull-out compartment, upper drawer including cut-out for siphon and siphon cover, 1 console with one cut-out, 820 x 550 mm	820 x 550 mm	LC4880
Vanity unit wall-mounted 1 drawer, 1 pull-out compartment, upper drawer including cut-out for siphon and siphon cover, 1 console with one cut-out, 1020 x 550 mm	1020 x 550 mm	LC4881
Vanity unit wall-mounted 1 drawer, 1 pull-out compartment, upper drawer including cut-out for siphon and siphon cover, 1 console with one cut-out, 1220 x 550 mm	1220 x 550 mm	LC4882
Vanity unit wall-mounted 2 drawers, 2 pull-out compartments, 1 countertop with one cut-out left or right, 1420 x 550 mm	1420 x 550 mm	LC4870 L/R
Vanity unit wall-mounted 2 drawers, 2 pull-out compartments, 1 countertop with one cut-out left or right, 1620 x 550 mm	1620 x 550 mm	LC4871 L/R
Vanity unit wall-mounted 2 drawers, 2 pull-out compartments, upper drawer including cut-out for siphon and siphon cover, 1 console with two cut-outs, 1420 x 550 mm	1420 x 550 mm	LC4872 B
Vanity unit wall-mounted 2 drawers, 2 pull-out compartments, upper drawer including cut-out for siphon and siphon cover, 1 console with two cut-outs, 1620 x 550 mm	1620 x 550 mm	LC4873 B
Vanity unit wall-mounted 2 drawers, 2 pull-out compartments, 1 console with one cut-out, 1220 x 550 mm	1220 x 550 mm	LC4874
Vanity unit wall-mounted 2 drawers, 2 pull-out compartments, 1 console with one cut-out, 1420 x 550 mm	1420 x 550 mm	LC4875
Vanity unit wall-mounted 2 drawers, 2 pull-out compartments, 1 console with one cut-out, 1220 x 550 mm	1220 x 550 mm	LC4876
Vanity unit wall-mounted 2 drawers, 2 pull-out compartments, 1 console with one cut-out, 1420 x 550 mm	1420 x 550 mm	LC4877

Recommended faucets

Single lever basin mixer for concealed installation normal spray, ceramic cartridge, aerator adjustable, connection type: basic set for concealed installation, includes: visible parts, recommended operating pressure 3 - 5 bar, Projection 174 mm,	C11070003
Single lever basin mixer XL ceramic cartridge, Projection 166 mm, flexible connection hoses 3/8", aerator adjustable, normal spray, recommended operating pressure 3 - 5 bar, without pop-up waste set,	C11040002
Single lever basin mixer for concealed installation normal spray, ceramic cartridge, aerator adjustable, connection type: basic set for concealed installation, includes: visible parts, recommended operating pressure 3 - 5 bar, Projection 225 mm,	C11070004
Single lever basin mixer XL ceramic cartridge, projection 180 mm, flexible connection hoses 3/8", normal spray, chrome, maximum temperature can be adjusted on installation, recommended operating pressure 3 - 5 bar, with pop-up waste set,	A11040001
Single lever basin mixer XL ceramic cartridge, projection 180 mm, flexible connection hoses 3/8", normal spray, chrome, maximum temperature can be adjusted on installation, recommended operating pressure 3 - 5 bar, without pop-up waste set,	A11040002
Single lever basin mixer L ceramic cartridge, projection 152 mm, flexible connection hoses 3/8", aerator adjustable, flow rate 5,0 l/min (3 bar), normal spray, chrome, maximum temperature can be adjusted on installation, recommended operating pressure 3 - 5 bar, without pop-up waste set,	B31030002
2-hole electronic basin mixer XL with built-in power supply electronic control via operating knob, temperature change simply by rotating visualized by color light change, locking function for ease of cleaning, flow rate 5,0 l/min (3 bar), maximum temperature and waterflow time can be set individually, Permanent waterflow for thermal disinfection activatable, hygienic flush adjustable, scalding protection, normal spray, aerator adjustable, projection 180 mm, recommended operating pressure 3 - 5 bar, without pop-up waste set, without volume control, includes: spout, electronic control unit, operating knob (cable length 1200 mm),	D11110008
2-hole electronic basin mixer XL with plug-in power supply electronic control via operating knob, temperature change simply by rotating visualized by color light change, locking function for ease of cleaning, flow rate 5,0 l/min (3 bar), maximum temperature and waterflow time can be set individually, Permanent waterflow for thermal disinfection activatable, hygienic flush adjustable, scalding protection, normal spray, aerator adjustable, projection 180 mm, recommended operating pressure 3 - 5 bar, without pop-up waste set, without volume control, includes: spout, electronic control unit, operating knob (cable length 1200 mm),	D11110007
2-hole basin mixer XL ceramic cartridge, flexible connection hoses 3/8", connection size DN15, normal spray, flow rate 5,0 l/min (3 bar), aerator adjustable, projection 180 mm, recommended operating pressure 3 - 5 bar, without pop-up waste set,	D11130002

D-Neo Washbowl # 2371400070

|< 400 mm >|

<p>2-hole basin mixer XL with turning handle ceramic cartridge, flexible connection hoses 3/8", connection size DN15, normal spray, flow rate 5,0 l/min (3 bar), aerator adjustable, projection 180 mm, recommended operating pressure 3 - 5 bar, without pop-up waste set,</p>	<p>D11130009</p>
<p>Single lever basin mixer L ceramic cartridge, Projection 139 mm, flexible connection hoses 3/8", aerator adjustable, normal spray, chrome, maximum temperature can be adjusted on installation, recommended operating pressure 3 - 5 bar, with pop-up waste set,</p>	<p>DE1030001</p>
<p>Single lever basin mixer L ceramic cartridge, Projection 139 mm, flexible connection hoses 3/8", aerator adjustable, normal spray, chrome, maximum temperature can be adjusted on installation, recommended operating pressure 3 - 5 bar, without pop-up waste set,</p>	<p>DE1030002</p>

All drawings contain the necessary measurements which are subject to standard tolerances. They are stated in mm and are non-binding. Exact measurements, in particular for customised installation scenarios, can only be taken from the finished piece.